

BLOCK A - GATE HOUSE:

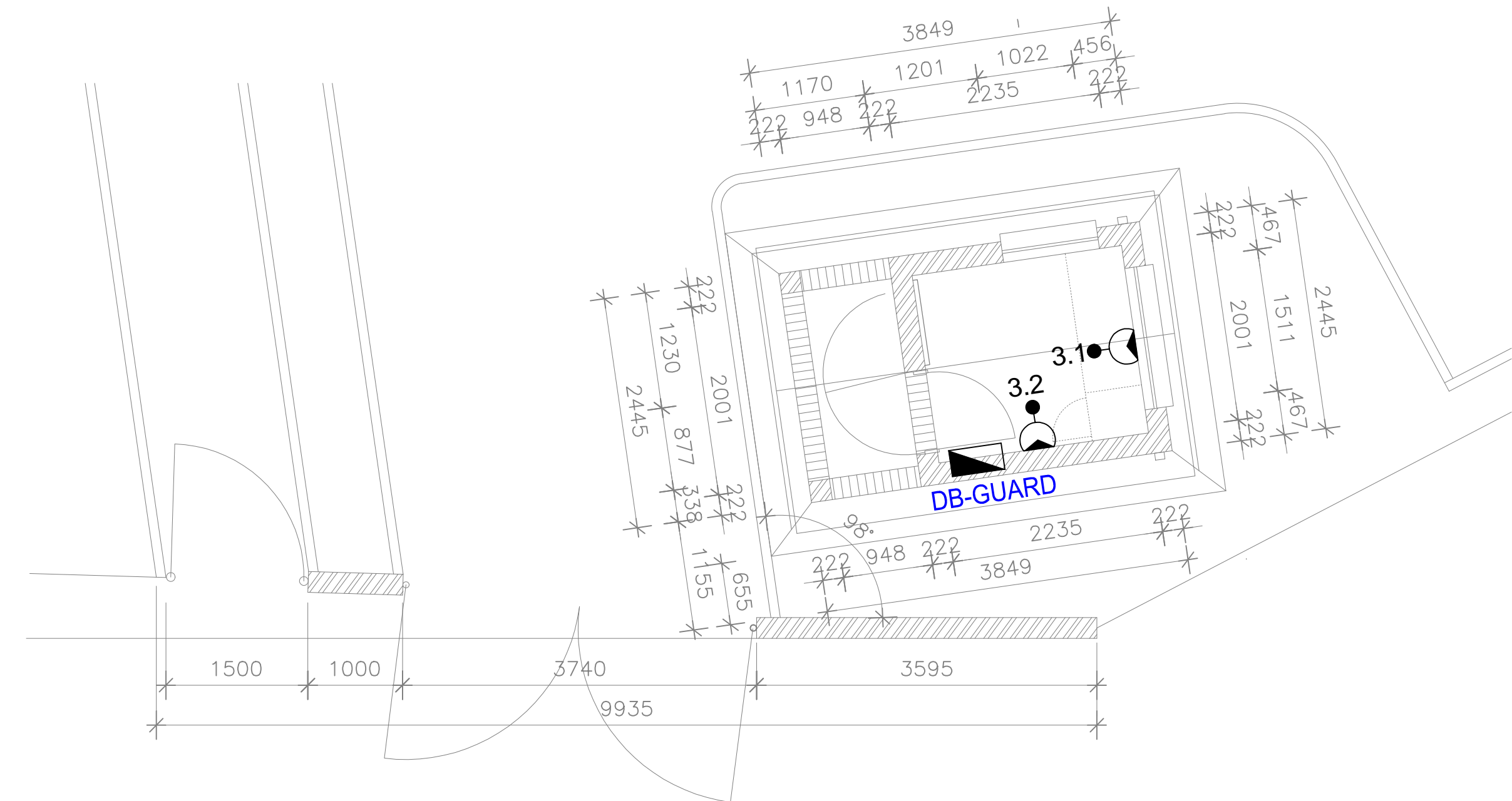
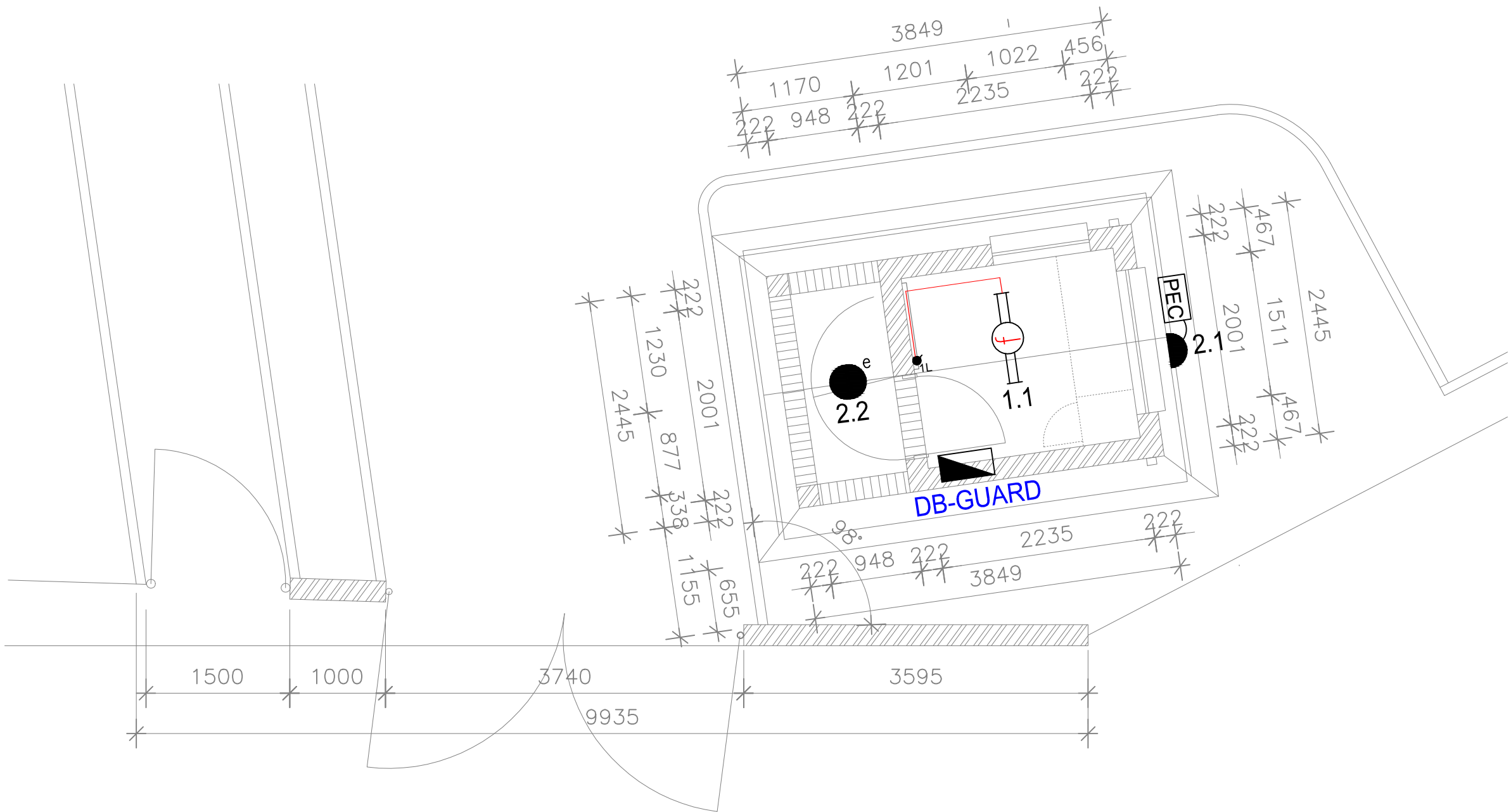

ELECTRICAL LEGEND			
	LED 6 W, 4000K, RECESSED FLAT PANEL DOWNLIGHT LUMINAIRE WITH WHITE TRIM.		SINGLE 16A SS - EURO SOCKET COMBO
	1500 mm, 2x24W, T8 LED OPEN CHANNEL		DUO SOCKET OUTLET
	1200 mm, 1x18W, T8 LED OPEN CHANNEL		THREE PHASE ISOLATOR
	ROUND 20W LED, 6500K BULKHEAD LUMINAIRE WITH BLACK TRIM AS IN BEKA 31126 or OTHER APPROVED		SINGLE PHASE ISOLATOR
	PHOTO ELECTRIC CELL		DB BOARD
	LIGHT SWITCH		INTERCOM OUTLET
	2 WAY LIGHT SWITCH		1200 mm, 2 x 18W, T8 LED SURFACE LUMINAIRE WITH LBR DIFFUSER
	WATERTIGHT LIGHT SWITCH		1200 mm, 2 x 18W, T8 LED VAPOUR PROOF FITTING
	TELEPHONE OUTLET		LOUD SPEAKER FOR PA SYSTEM
	COMPUTER DATA OUTLET		MICROPHONE FOR PA SYSTEM
	SCHOOL SIREN PUSH BUTTON @ UNDERCOUNTER HEIGHT		AMPLIFIER FOR PA SYSTEM
	ALARM MOTION SENSOR		ALARM KEY PAD
	ALARM CONTROL BOX		ALARM BELL

- NOTES :
- 1.0 ALL POWER SKIRTING TO BE MOUNTED AT FINISHED FLOOR LEVEL UNLESS OTHERWISE STATED.
  - 2.0 ALL OTHER 16 A SWITCHED SOCKETS OUTLETS TO BE MOUNTED AT 300 mm AFFL
  - 3.0 ALL EXTERIOR LIGHTING TO BE MOUNTED AT A 2200 MM HEIGHT AFFL

REV	DATE	DESCRIPTION	DR	CK
-----	------	-------------	----	----

CLIENT:

  
Department:  
Education  
PROVINCE OF KWAZULU-NATAL  
Head Office, 247 Burger Street, Pietermaritzburg, 3200  
Telephone Number: (033) 392 1203  
Fax number: (033) 392 1203

IMPLEMENTING AGENT :

  
DEVELOPMENT BANK OF SOUTHERN AFRICA  
Building Africa's Prosperity  
Headway Hill, 1258 Lever Road, Midrand, South Africa  
Telephone Number: +27 11 313 3011  
Fax number: +27 11 313 3000 or +27 11 313 3297  
Web: webmaster@dbsa.org

PROFESSIONAL SERVICE PROVIDER :

  
Bhadama  
Properties & Projects  
Rogus Westway, 3 Floor, 18 The Boulevard  
Westway Office Park, Westway, CLS 504  
Tel: (031) 003 3137, Fax: (031) 003 3191, FTS: 086 671 3802  
dbp@bhadama.co.za

ARCHITECT:

  
PROJECTS  
ARCHITECTS | PROJECT MANAGERS

PROJECT :  
EXHAPHOZINI PRIMARY SCHOOL

SERVICE :  
ELECTRICAL

  
ENGINEERS, PLANNERS AND PROJECT MANAGERS  
37 LESLEY DRIVE  
HATTON ESTATE  
PINETOWN,  
3610  
TEL : 083-362 4784  
FAX : 086-635 1149  
e-mail address :  
trm@ngolela.co.za

DRAWING TITLE:  
GUARD HOUSE  
LIGHTING AND SMALL POWER LAYOUT

DESIGNED: T.N. MAPHUMULO	APPROVED: T.N. MAPHUMULO	
SIGNATURE:	SIGNATURE:	
DRAWN: PBM	DRAWING NUMBER	REV.
DATE: 31.08.2022		
SCALE: 1:50	2209-EL, EP-04	0